

Interior view of installation (Front)

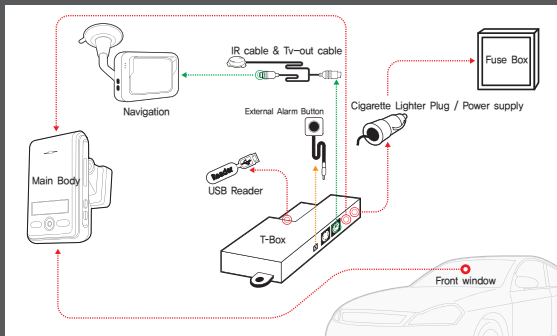

Product configuration

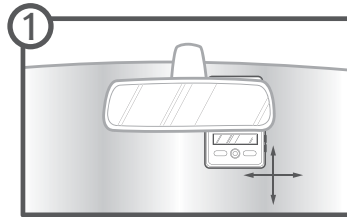

1 Place the product on the windshield as picture and then clean up the windshield to install. Remove the cover of sticker on the bracket and put the product (with bracket) on the windshield.

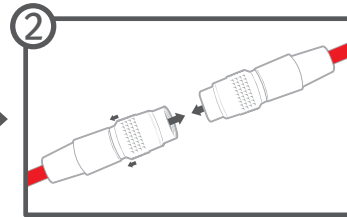

2 Connect the cable from T-box and the main body.

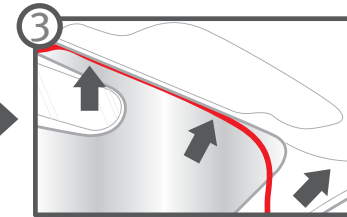

3 For the neat installation, put the cable into the gap between windshield and the ceiling as picture.

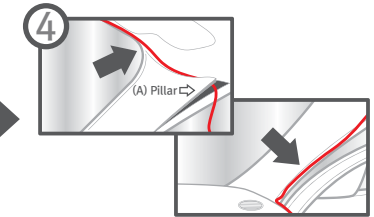

4 Dismantle A pillar like the picture and then put the cable into the rubber molding.

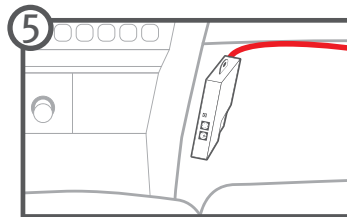

5 Place the T-Box to install and fix (attach) the T-Box with sticker or screws.

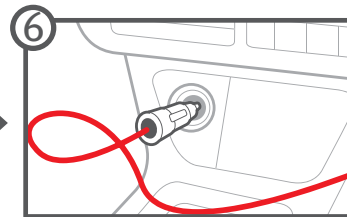

6 Connect the cigar lighter plug into cigar lighter to power on.

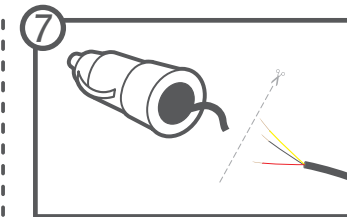

7 For parking surveillance, cut the cigar lighter plug like picture and then connect the wires to the fuses in the fuse box.

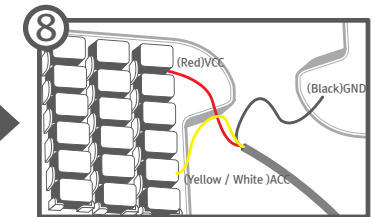

8 While connecting the wire to the fuse, please connect "ground wire" first.

TIP Recommended points :
underneath of driver seat, dashboard, underneath

• The cable color will be
(red / yellow / black) or (red / white / black)

- Red - VCC (internal light, emergency light for all-time power supply)
- Yellow or white - ACC (cigar lighter power)
- Black - GND (car frame)

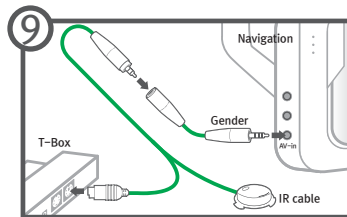

9 In order to see the live view from the product, please connect T-box and the monitor with the gender like picture.

• You may purchase the gender for the monitor if in need.

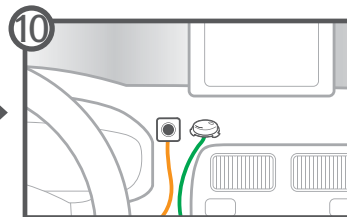

10 Place and install the external alarm button receiver at convenient place to use. Install the remote controller receiver at visible place to use.

Caution

- Please read the manual carefully before installing the product.
- Please ignition off before installing the product.
- For parking surveillance, the cigar lighter jack should be removed.
- For parking surveillance, please ask the mechanic or technician for assistance.
- The fuse box may vary. Please check the vehicle manual before the installation.
- The Cabling can be done by the user's convenience.

